

MARIAN ENGINEERING COLLEGE KAZHAKUTTOM

BOARDING POINTS, DISTANCE AND FEES FOR THE MONTH OF MARCH

Bus Route No. 4

Station No	Boarding Point	Distance in Kms	Morning Time	Evening Time	Bus Fees for Month of March-2021
1	MEC	0	8.45	4.10	
2	St. Andrew's	2	8.40	4.15	680
3	Puthenthope	3	8.35	4.20	680
4	Vettuthura	4	8.30	4.25	680
5	Santhipuram	5	8.25	4.30	680
6	Marianadu	6	8.20	4.35	750
7	Puthukurichy	10	8.15	4.40	1250
8	Perumathura	14	8.10	4.45	1600
9	Thazhampally	17	8.05	4.50	1800
10	Anathalavattom	21	8.00	4.55	2200
11	Chekkalavilakam mukku	21	7.55	5.00	2200
12	Anjuthengu	23	7.50	5.05	2200
13	Nedungada	27	7.45	5.10	2300
14	Vetoor	29	7.40	5.15	2300
15	Puthenchantha	31	7.35	5.20	2300
16	Varkala	34	7.30	5.25	2400

Bus co-ordinator- Anil.No. 9847603517

Very Rev. Msgr. Wilfred. E
MANAGER

Rev. Fr. Sudheesh
BURSAR

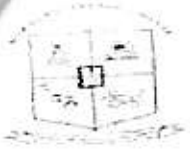

MARIAN ENGINEERING COLLEGE KAZHAKUTTOM

BOARDING POINTS, DISTANCE AND FEES FOR THE MONTH OF MARCH

Bus Route No. 10

Station No	Boarding Point	Distance in Kms	Morning Time	Evening Time	Bus Fees for Month of March - 2021
1	MEC	0	8.45	4.10	
2	Sreekaryam	6	8.35	4.15	1150
3	Loyola School	7	8.30	4.20	1250
4	Cheruvaikkal	8	8.25	4.25	1280
5	Cheruvaikkal Sree Narayana Guru	9	8.20	4.30	1400
6	Pulayanarkotta Junction	10	8.15	4.35	1500
7	Prasanth Nagar	11	8.10	4.40	1600
8	More (Sree Narayana Guru Mandhiram)	12	8.05	4.45	1600
9	Kesavadasapuram	12	8.00	4.50	1600
10	PMG	17	7.55	4.55	1800
11	Palayalam	18	7.50	5.00	1800
12	Nanthancode Junction	18	7.45	5.05	1900
13	Devaswamboard Junction	18	7.40	5.10	1900
14	Vellayambalam	19	7.30	5.20	2000

Bus co-ordinator - Anil.No. 9847603517

Very Rev. Msgr. Wilfred. E
MANAGER

Rev. Fr. Sudheesh
BURSAR



MARIAN ENGINEERING COLLEGE KAZHAKUTTOM

BOARDING POINTS, DISTANCE AND FEES FOR THE MONTH OF MARCH

Bus Route No. 14

Station No	Boarding Point	Distance in Kms	Morning Time	Evening Time	Bus Fees for Month of March-2021
1	MEC	0	8.45	4.10	
2	Kazhakuttom	2	8.35	4.15	680
3	Technopark	6	8.30	4.20	700
4	Margin Free Market	7	8.25	4.25	900
5	Kuzhivila	8	8.20	4.30	1000
6	World Market	10	8.15	4.35	1200
7	Anayara	10	8.10	4.40	1200
8	Chakkai	13	8.05	4.45	1500
9	Enchackal	15	8.00	4.50	1750
10	Muttathara-I	16	7.55	4.55	1750
11	Muttathara-II	17	7.50	5.00	1800
12	Ambalathara	19	7.45	5.05	2000
13	Kumarichantha	19	7.42	5.10	2000
14	Paravankunnu	20	7.40	5.15	2100
15	Kallattumukku	20	7.38	5.20	2100
16	Kamaleswaram	21	7.35	5.25	2200
17	Manacaud	18	7.30	5.30	1900
18	Killippalam	19	7.27	5.35	2000
19	Thycaud	22	7.25	5.40	2200
20	Mettukkada	20	7.24	5.45	2100
21	Vazhuthacaud	18	7.22	5.50	1900
22	Vellayambalam	19	7.20	5.55	2000

Bus co-ordinator - Anil.No. 9847603517

Very Rev. Msgr. Wilfred. E
MANAGER

Rev. Fr. Sudheesh
BURSAR



MARIAN ENGINEERING COLLEGE KAZHAKUTTOM

BOARDING POINTS, DISTANCE AND FEES FOR THE MONTH OF MARCH

Bus Route No. 15

Station No	Boarding Point	Distance in Kms	Morning Time	Evening Time	Bus Fees for Month of March - 2021
1	MEC	0	8.45	4.10	
2	Ulloor	12	8.40	4.15	1400
3	Medical College	13	8.35	4.20	1500
4	Kumarapuram	14	8.30	4.25	1650
5	Kannammoola	15	8.25	4.30	1750
6	Pallimukku	14	8.20	4.35	1650
7	General Hospital	16	8.15	4.40	1750
8	Palayam	17	8.10	4.45	1800
9	Vazhuthacaud	18	8.05	4.50	1900
10	Jagathi	22	8.00	4.55	2200
11	Poojappura	23	7.55	5.00	2200
12	Police Station - Poojapura	23	7.50	5.05	2200
13	Vijayamohini Mill	25	7.45	5.10	2200
14	Thirumala	22	7.40	5.15	2200
15	Valiavilla	23	7.35	5.20	2200
16	Vettamukku	24	7.30	5.25	2200
17	Marudhamkuzhi	20	7.25	5.30	2100
18	Vellayambalam	19	7.20	5.35	2000

Bus co-ordinator - Anil.No. 9847603517

Very Rev. Msgr. Wilfred. E
MANAGER

Rev. Fr. Sudheesh
BURSAR

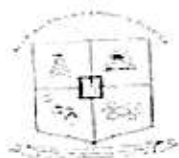

MARIAN ENGINEERING COLLEGE KAZHAKUTTOM

BOARDING POINTS, DISTANCE AND FEES FOR THE MONTH OF MARCH

Bus Route No. 16					
Station No	Boarding Point	Distance in Kms	Morning Time	Evening Time	Bus Fees for Month of March - 2021
1	MEC	0	8.45	4.10	
2	Sreekariyam	9	8.40	4.15	1150
3	Poudikonam	11	8.35	4.20	1500
4	Kariyam	13	8.30	4.25	1750
5	Mannanthala	14	8.27	4.30	1900
6	Kottamukal	16	8.25	4.35	1800
7	Step Junction	16	8.20	4.40	1750
8	Kurishadi Junction	15	8.15	4.45	1750
9	Nalanchira - Main Gate	15	8.10	4.50	1750
10	Paruthipara	16	8.05	4.55	1650
11	Muttada	16	8.00	5.00	1750
12	Vayalikkada	17	7.55	5.05	1750
13	Ambalamukku	17	7.50	5.10	1800
14	Peroorkada	18	7.45	5.15	1900
15	Vazhayila	19	7.40	5.20	2000
16	Karakulam	21	7.35	5.25	2200
17	Azheekode	23	7.30	5.30	2200
18	Pathamkallu	25	7.25	5.35	2200
19	Nedumangad	27	7.20	5.40	2300

Bus co-ordinator - Anil.No. 9847603517

Very Rev. Msgr. Wilfred. E

MANAGER

Rev. Fr. Sudheesh

BURSAR



MARIAN ENGINEERING COLLEGE
KAZHAKUTTOM

BOARDING POINTS, DISTANCE AND FEES FOR THE MONTH OF MARCH

Bus Route No. 19

Station No	Boarding Point	Distance in Kms	Morning Time	Evening Time	Bus Fees for Month of March-2021
1	MEC	0	8.45	4.10	
2	Mission Hospital	3	8.40	4.15	680
3	Vetturoad	4	8.37	4.20	680
4	Chanthavila	7	8.35	4.25	900
5	Kattayikkonam	9	8.30	4.30	1150
6	Pothencode	11	8.25	4.35	1280
7	Thycaud	18	8.20	4.40	1900
8	Venjaramoodu	18	8.15	4.45	1900
9	Kattakkal	18	8.10	4.50	1900
10	Chemboor	18	8.05	4.55	1900
11	Pointmukku	18	8.00	4.60	1900
12	Avanavan cheri	18	7.55	5.00	1900
13	Moonnumukku	18	7.50	5.05	1900
14	Attingal	19	7.45	5.10	2000
15	CSI Attingal	19	7.40	5.15	2000
16	Alamcode	22	7.30	5.25	2200

Bus co-ordinator- Anil- No.9847603517

Very Rev. Msgr. Wilfred. E
MANAGER

Rev. Fr. Sudheesh
BURSAR

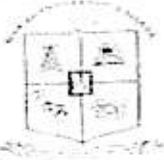

MARIAN ENGINEERING COLLEGE KAZHAKUTTOM

BOARDING POINTS, DISTANCE AND FEES FOR THE MONTH OF MARCH

Bus Route No. 21					
Station No	Boarding Point	Distance in Kms	Morning Time	Evening Time	Bus Fees for Month of March-2021
1	MEC	0	8.40	4.10	
2	Kazhakuttom	2	8.35	4.15	680
3	Kallampally	10	8.30	4.20	1250
4	Pongumoodu - SUT Water Tank	11	8.25	4.25	1300
5	Kesavadasapuram	14	8.20	4.30	1600
6	LIC	15	8.15	4.35	1750
7	Pattom	16	8.10	4.40	1750
8	Plamoodu	17	8.05	4.45	1800
9	Kuravankonam	16	8.00	4.50	1750
10	Kowdiar	18	7.55	4.55	1900
11	Mannamoola	18	7.50	5.00	1900
12	Melethu Melai	20	7.45	5.05	2100
13	Vattiyoorkavu	21	7.40	5.10	2200
14	Kanjirampara	22	7.35	5.15	2200
15	Maruthankuzhy	20	7.30	5.20	2100
16	Sasthamangalam	19	7.25	5.25	2000
17	Vellayambalam	19	7.20	5.30	2000

Bus co-ordinator no. 9847603517

Very Rev. Msgr. Wilfred. E
MANAGER

Rev. Fr.
BURSAR

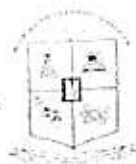

MARIAN ENGINEERING COLLEGE
KAZHAKUTTOM

BOARDING POINTS, DISTANCE AND FEES FOR THE MONTH OF MARCH

Bus Route No. 22

Station No	Boarding Point	Distance in Kms	Morning Time	Evening Time	Bus Fees for Month of March -2021
1	MEC	0	8.45	4.10	
2	Kazhakuttom	2	8.40	4.15	680
3	Kaniyapuram	5	8.30	4.20	680
4	Pallippuram	7	8.20	4.25	900
5	Thonnaikkal	8	8.10	4.30	1000
6	Chempakamangalam	12	8.00	4.40	1400
7	Korani	14	7.60	4.45	1600
8	T. B. Junction	20	7.50	4.50	2100
9	Alamcode	22	7.40	4.55	2200
10	Kallambalam	27	7.35	5.05	2300
11	Parippally	34	7.30	5.10	2400

Bus co-ordinator - Anil . No. 9847603517

Very Rev. Msgr. Wilfred. E
MANAGER

Rev. Fr. Sudheesh
BURSAR



MARIAN ENGINEERING COLLEGE KAZHAKUTTOM

BOARDING POINTS, DISTANCE AND FEES FOR THE MONTH OF MARCH

Bus Route No. 23

Station No	Boarding Point	Distance	Morning Time	Evening Time	Bus Fees for Month of March -2021
1	MEC	0	8.45	4.10	
2	Thumba	2	8.42	4.12	680
3	Pallithura	3	8.40	4.15	680
4	Nehru Junction	4	8.35	4.17	680
5	Stationkadavu	5	8.30	4.20	680
6	Valiyaveli	7	8.25	4.25	900
7	Madhavapuram	8	8.20	4.30	1000
8	Kochuveli	8	8.15	4.35	1000
9	All Saint's	11	8.10	4.40	1280
10	Chakkai	13	8.05	4.45	1500
11	Enchackal	15	8.00	4.50	1750
12	Thiruvallam	21	7.55	4.55	2200
13	Pachalloor	23	7.50	5.00	2200
14	Kovalam	28	7.45	5.05	2200
15	Vizhinjam	29	7.40	5.10	2200
16	Mukkola	33	7.35	5.15	2200
17	Pulimkudy	35	7.30	5.17	2400
18	Marappalam	38	7.27	5.20	2400
19	Kochupally	39	7.25	5.22	2400
20	Pulluvila	40	7.22	5.25	2400
21	Puthiyathura	41	7.19	5.30	2500
22	Karumkulam	43	7.17	5.35	2500
23	Poovar	45	7.15	5.40	2500

Bus co-ordinator - Anil . No. 9847603517

Very Rev. Msgr. Wilfred. E
MANAGER

Rev. Fr. Sudheesh
BURSAR



MARIAN ENGINEERING COLLEGE KAZHAKUTTOM

BOARDING POINTS, DISTANCE AND FEES FOR THE MONTH OF MARCH

Bus Route No. 24

Station No	Boarding Point	Distance in Kms	Morning Time	Evening Time	Bus Fees for Month of March - 2021
1	MEC	0	8.45	4.10	
2	Kazhakuttom	2	8.40	4.15	680
3	Infosys	6	8.37	4.17	750
4	Kuzhivila	8	8.35	4.20	1000
5	Lords Hospital	11	8.33	4.25	1300
6	Satheendra Auditorium	12	8.32	4.30	1400
7	Sreevaraham Junction	17	8.30	4.35	1800
8	Karamana	20	8.27	4.37	2100
9	Niramankara	21	8.23	4.40	2200
10	Kaimanam	21	8.20	4.45	2200
11	Pappanamcode	22	8.15	4.50	2200
12	White Damor Hotel Junction	22	8.10	4.55	2200
13	Vellayani Junction	24	8.05	5.00	2200
14	Nemom Junction	25	8.00	5.05	2200
15	Nemom School Junction	26	7.55	5.10	2200
16	Pravachambalam Junction	26	7.50	5.15	2200
17	Vedivachaan Kovil	29	7.45	5.20	2300
18	Mudavoorpaara	30	7.40	5.25	2300
19	Balaramapuram	31	7.35	5.30	2300
20	Aaralumoodu (Vazhimukku)	33	7.30	5.35	2300
21	NIMS	34	7.25	5.40	2400
22	TV Junction	36	7.22	5.45	2400
23	Aalumood Junction	36	7.20	5.50	2400
24	Neyyattinkara Bus Stand Junction	37	7.17	5.55	2400
25	Vlangamuri Animation Centre	39	7.15	6.00	2400

Bus co-ordinator - Anil.No. 9847603517

Very Rev. Msgr. Wilfred E
MANAGER

Rev. Fr. Sudheesh
BURSAR